

SECTION C-C

Note:

1. Appearance: Terminal cannot be corrected, scratched or oxidized
2. Material: Brass [2680, T=0.35mm, Tin plating
3. Q'TY: 8000PCS/REEL
4. Connectoin Table: W4.75xT0.5mm
5. Wire Range: 18~20AWG

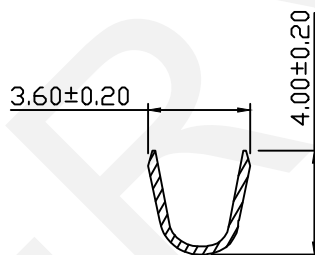
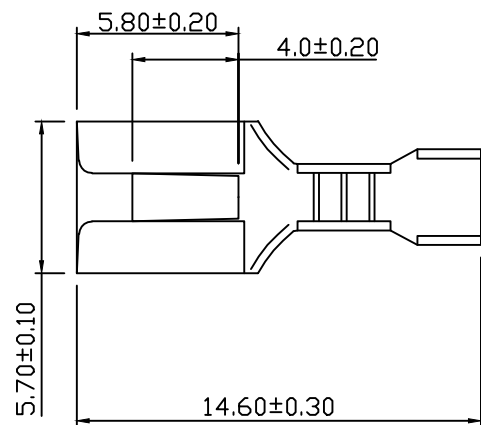

SECTION A-A

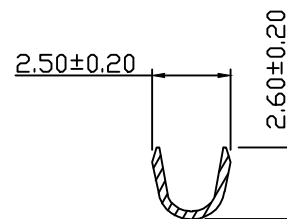

SECTION B-B

NINGBO ERYCO ELECTRONIC CO.,LTD

UNITS:mm	SHEET SIZE: A4	SCALE:---	DRWN BY PAN
0~3	3~18	18~50	50~120
±0.12	±0.15	±0.3	±0.5

CHK'D BY FENG
APPR BY ZHAN

187 Type Straight Female TERM. with Latch

THIRD ANGLE PROJECTION

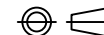

ERYHY-FT01-1870500